

Tempelhof airport in Berlin

Tempelhof : from
wasteland to
democratic factory,
reinventing the city
through consultation



Tempelhofer Feld © visitBerlin

Introduction



Map of Germany's 16 Länder

© Cartograf.fr

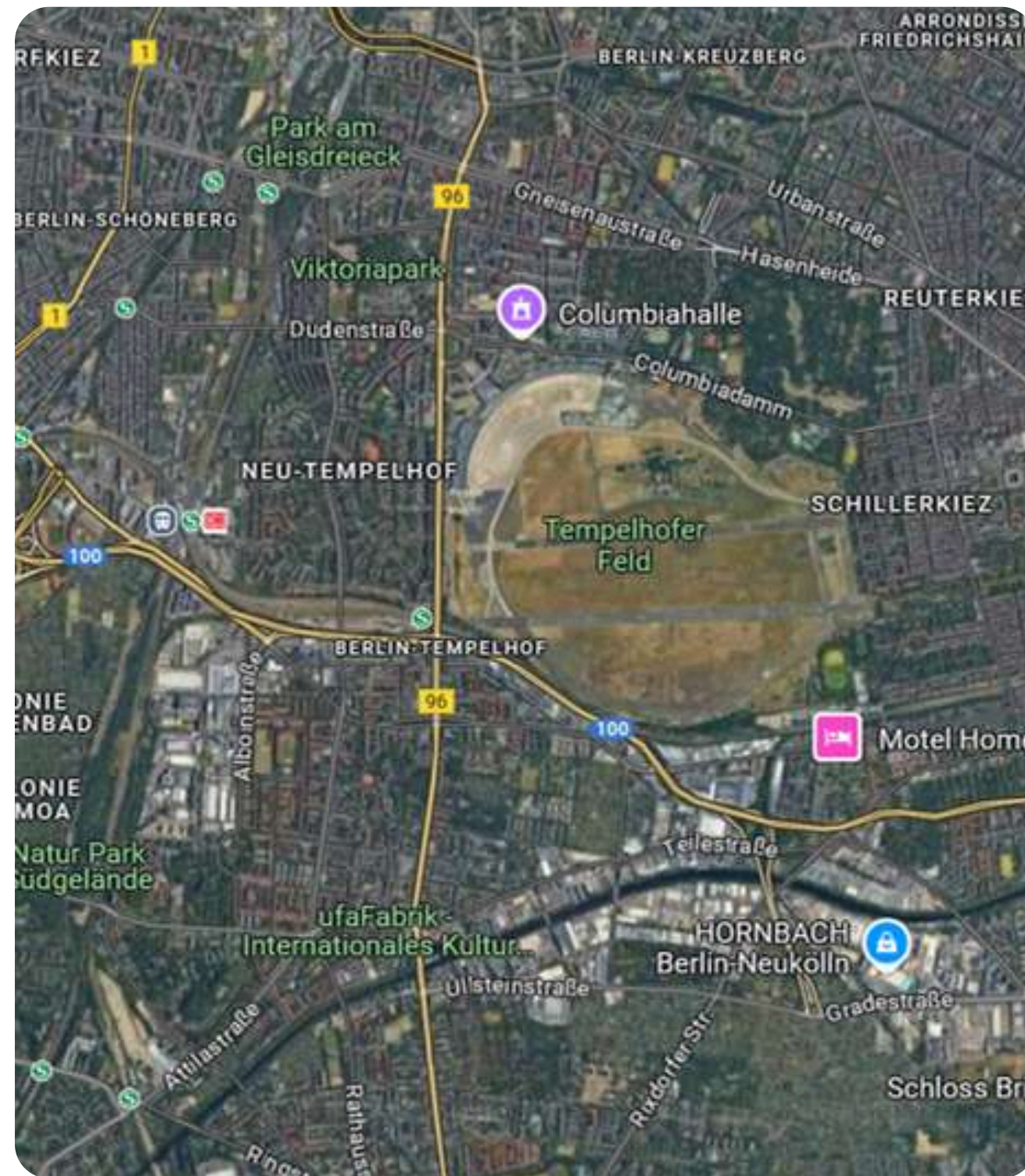

Aerial view of Tempelhof and surroundings

© Google Maps



Picture of Tempelhofer Feld

© Goethe-institut



Is the Tempelhof site an example of an original and alternative form of governance, involving citizens in public decision-making? What are the challenges and responses brought about at local level by collaboration between public authorities and residents?



Index

I. Tempelhof: between memory, history, attachment and symbolism

II. Political context: a federal system that gives power to the local level

III. Consultation: a key tool for urban development

IV. Key challenges and issues facing the site

V. Future prospects: challenges and changes in our heritage

I. Tempelhof: between memory, history, attachment and symbolism

1933-1945



Airport terminal in 1936 © luftfahrtarchiv-koeln.de

- Symbol of the violence of a totalitarian regime (used as a concentration camp)
- Memorial to the victims of Nazi regime

1945-1991



Bombardier on approach to Tempelhof airport in West Berlin © Keystone - Photopress-Archiv

Symbolism reversed during the blockade of West Berlin: Tempelhof becomes the symbol of resistance and attachment to the Western European system (parliamentary democracy, freedom).

II. Political context : a federal system that gives power to the local level

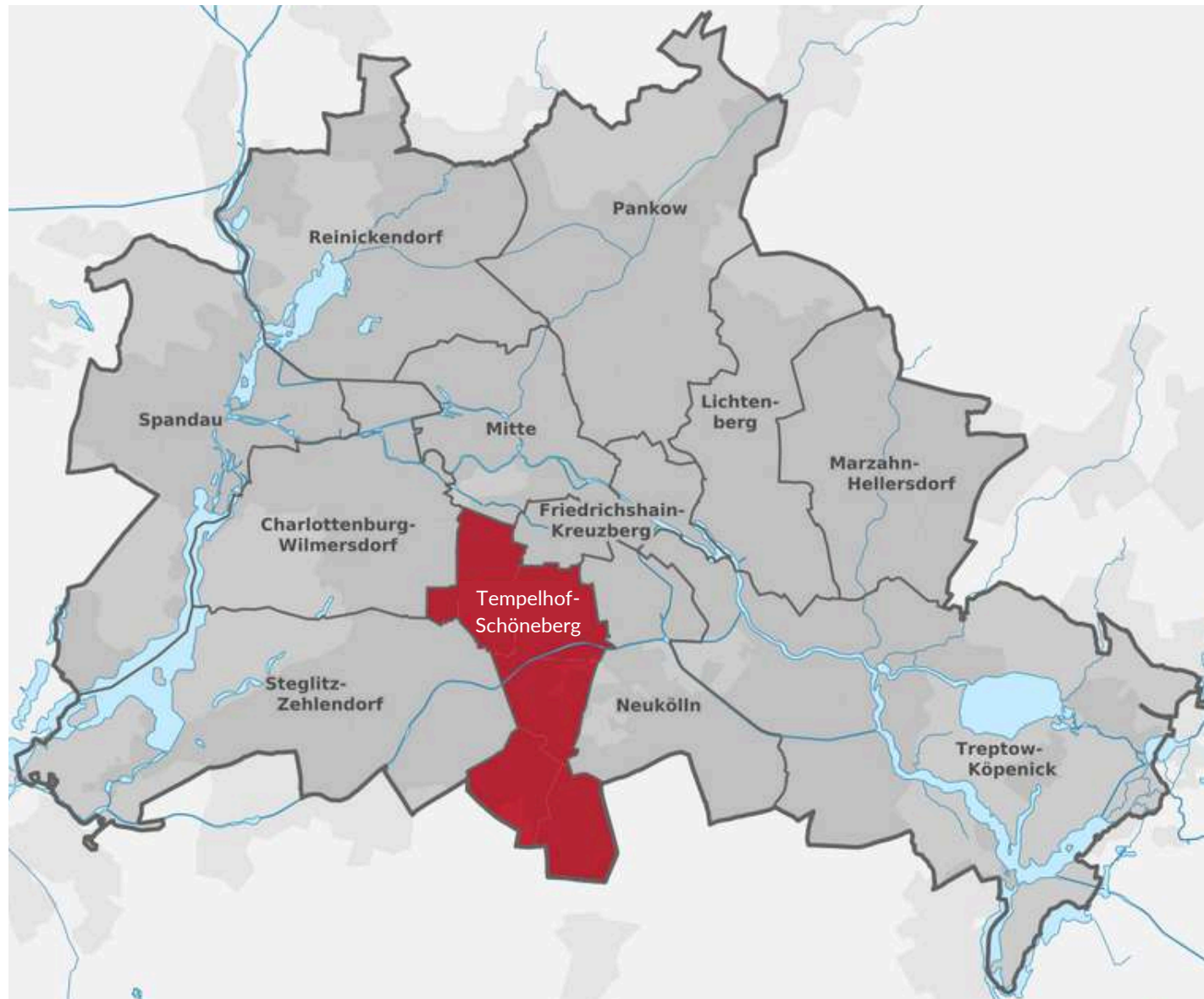

Map of Berlin's arrondissements - © Wikipédia

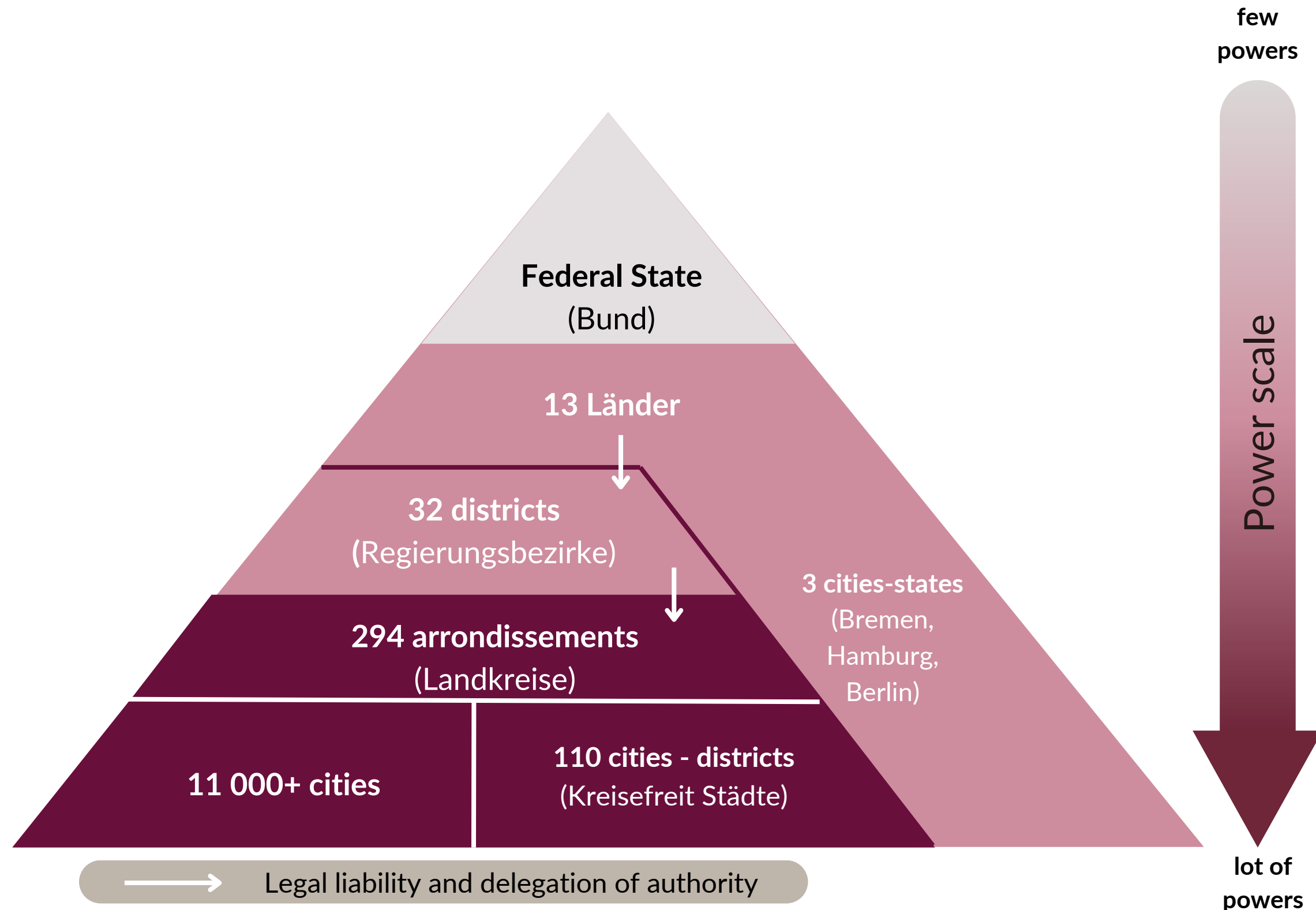

→ Legal liability and delegation of authority

Diagram of territorial division of German federal operation © Sia Partners

III- Consultation : a key tool for urban development

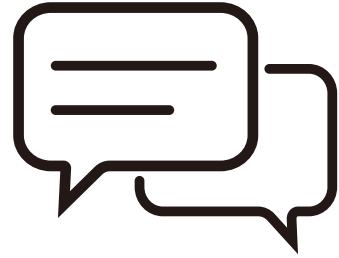
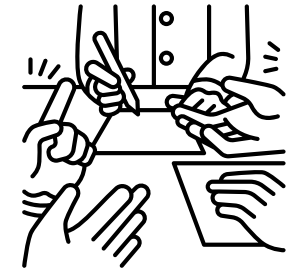

👉 2011 : Creation of the “100% Tempelhofer Feld” association

👉 2013 : Petition launched

👉 May 25, 2014 : Referendum on the future of the site

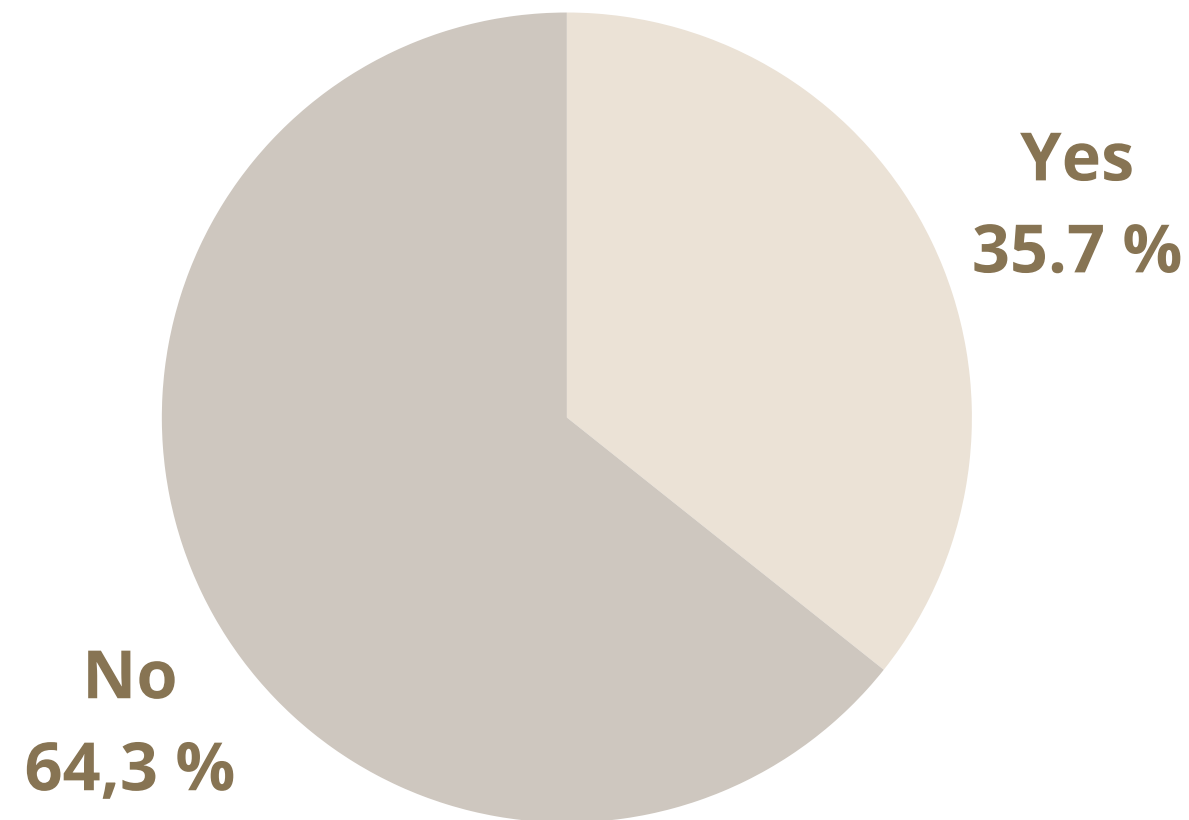

Graph showing the results of the 2014 referendum for the creation of the housing project

Some additional information on the vote:

- 740,708 votes **against the housing project** (no)
- 410,801 votes to **allow the housing project** (yes)

With a 46.7% participation rate

IV. Key challenges and issues facing the site

Governance and tensions

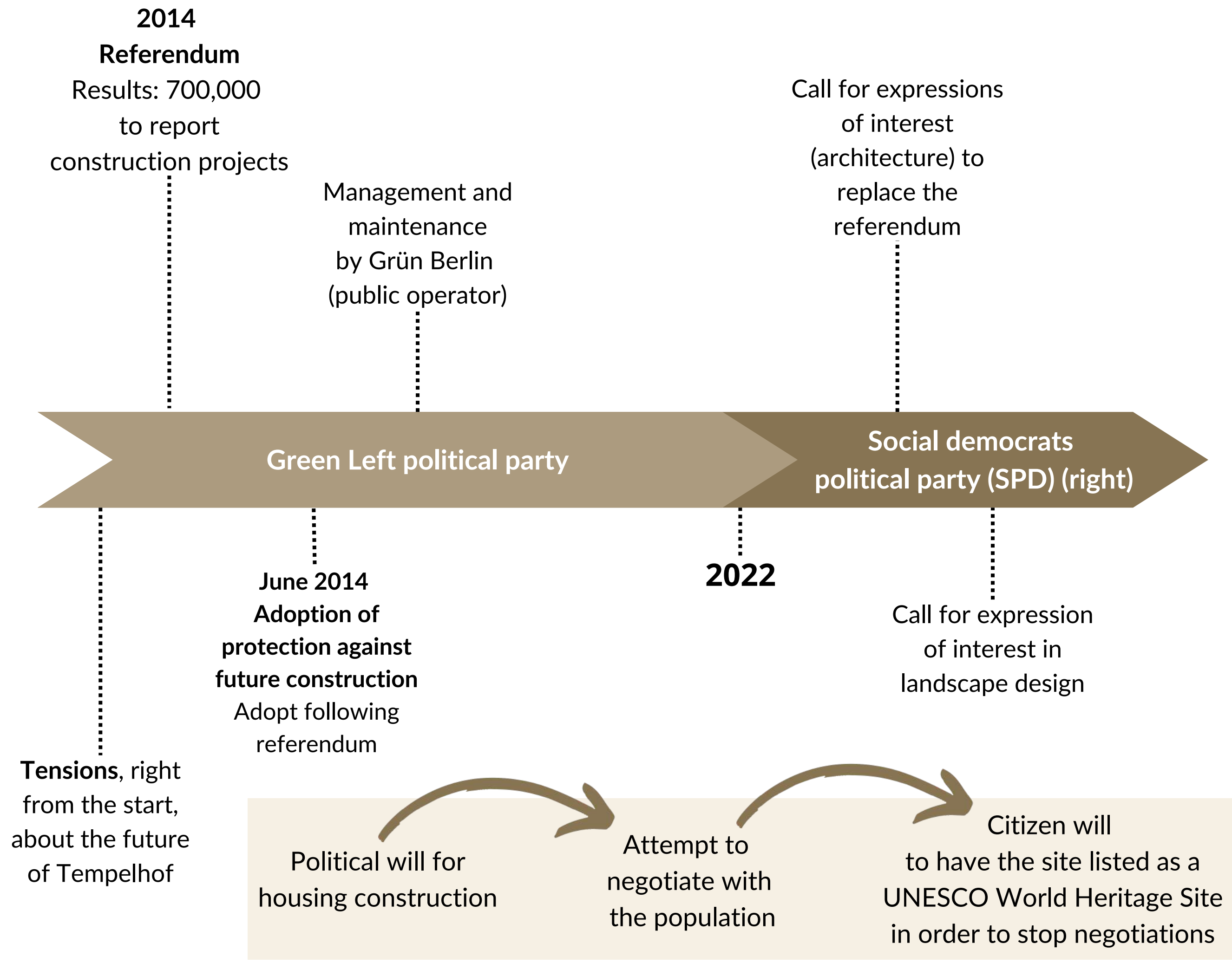

2014
Referendum
Results: 700,000
to report
construction projects

Management and
maintenance
by Grün Berlin
(public operator)

Call for expressions
of interest
(architecture) to
replace the
referendum



June 2014
Adoption of
protection against
future construction
Adopt following
referendum

2022

Call for expression
of interest in
landscape design

Tensions, right
from the start,
about the future
of Tempelhof

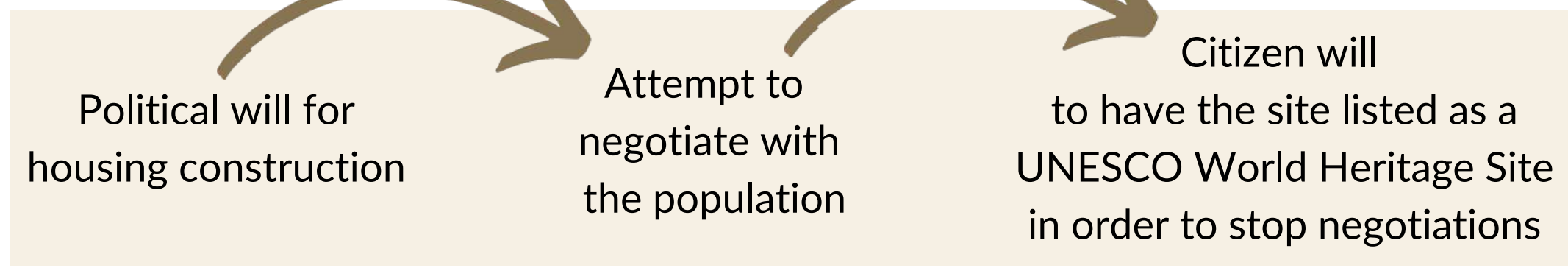

IV. Key challenges and issues facing the site

A strong environmental dimension



- A 300-hectares public park
- Extensive meadows rich in biodiversity
- Rare species identified
- Microclimate in the heart of the city



TEMPELHOFFER FELD PRESERVATION LAW (THF)

- Recognition of the site's ecological, memorial and historical values
- Sanctuarization of meadows
- Prohibition of all permanent constructions
- Preservation of community gardens

TODAY, THE TEMPELHOFFER FELD IT'S...

MANY OUTDOOR ACTIVITIES



- Walks on the slopes
- Rollerblading, cycling
- Tennis
- Soccer
- Basketball
- Skatepark
- ..

ENVIRONMENTAL EDUCATION



Nature tours



Green classes



Nature experience

© TempelhoferFeld.de

COMMUNITY GARDENS



© Allmende-Kontor

- Managed by Allmende-Kontor Association
- + 500 gardeners
- 5 000 m²



IV. Key challenges and issues facing the site

Planning

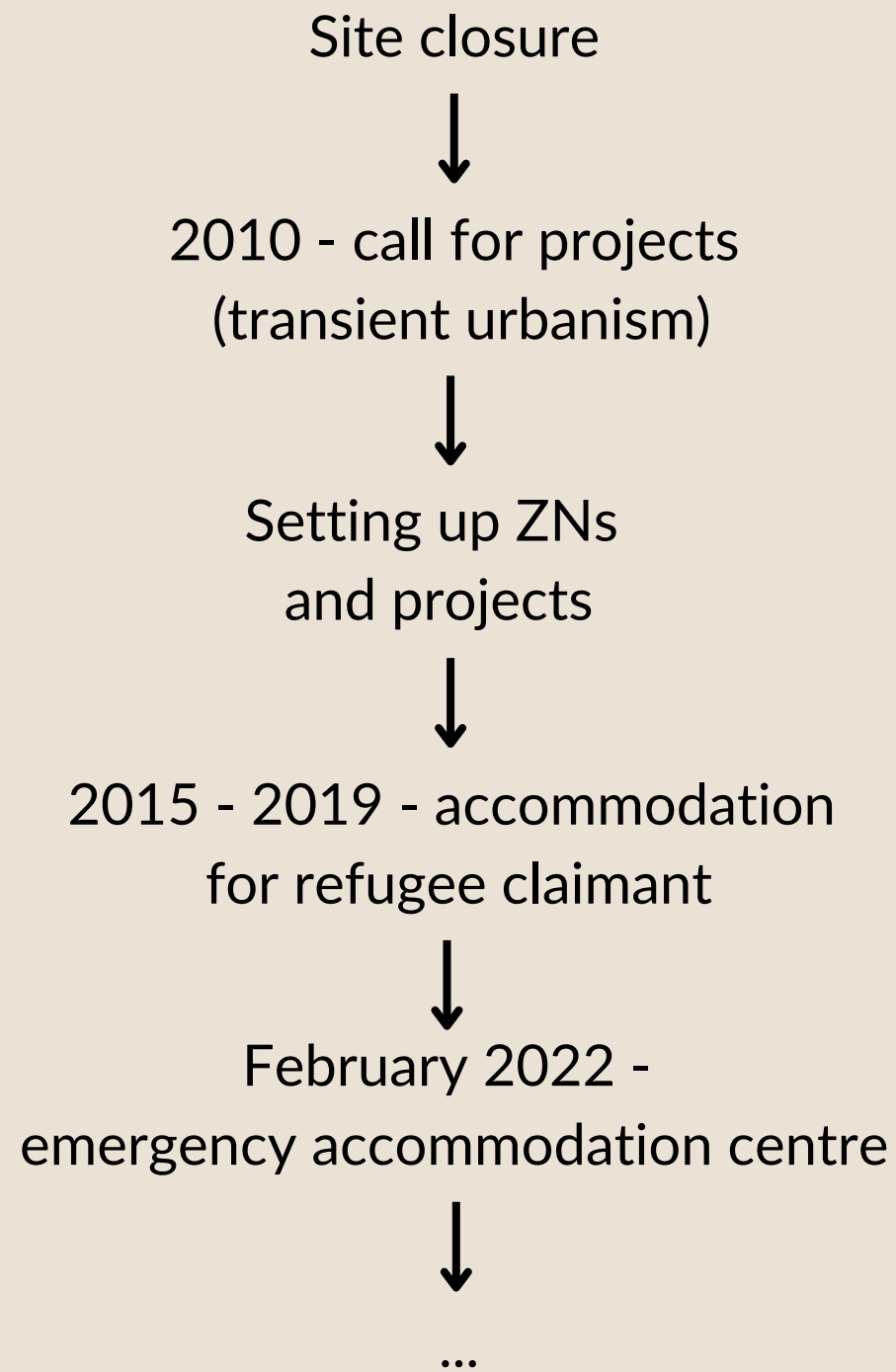

TRANSIENT URBANISM (ZWISCHENNUTZUNG)

- Temporary development project pending definitive project
- Site maintenance
- Place still integrated into the living space of local residents

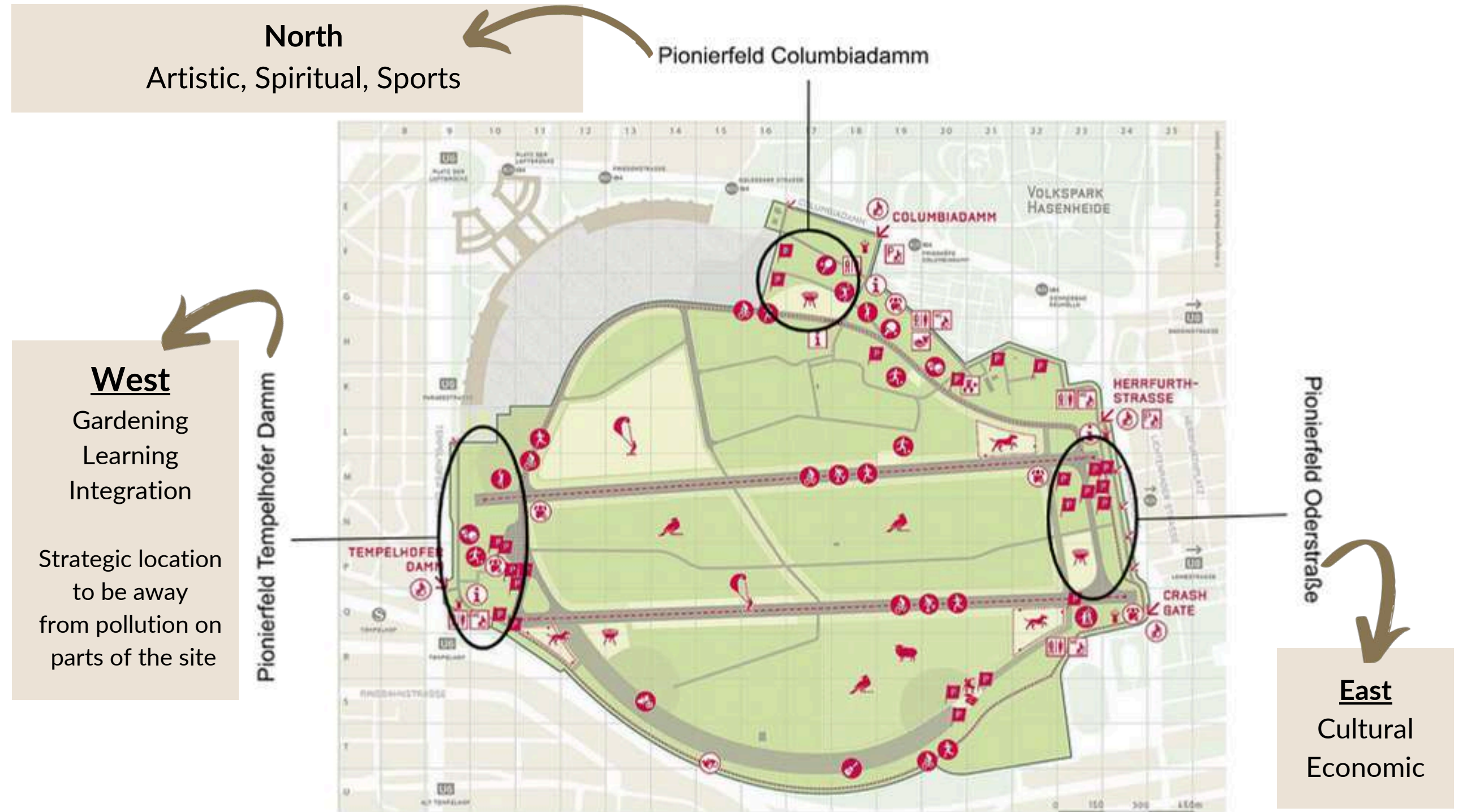

V. Future prospects : challenges and changes in our heritage

HERITAGE VS NEW NEIGHBORHOOD : A BALANCE IN PERSPECTIVE

■ A process of patrimonialisation :

- A large building at the heart of strong symbolism
- A listed site
- UNESCO becomes a tool

■ The city's housing policy :

- A vast field in the heart of the city
- Respond to the demand for housing in Berlin

■ A controversial balance :

- Citizen consultation initiatives
- Vision 2030+
- Cultural and artistic events

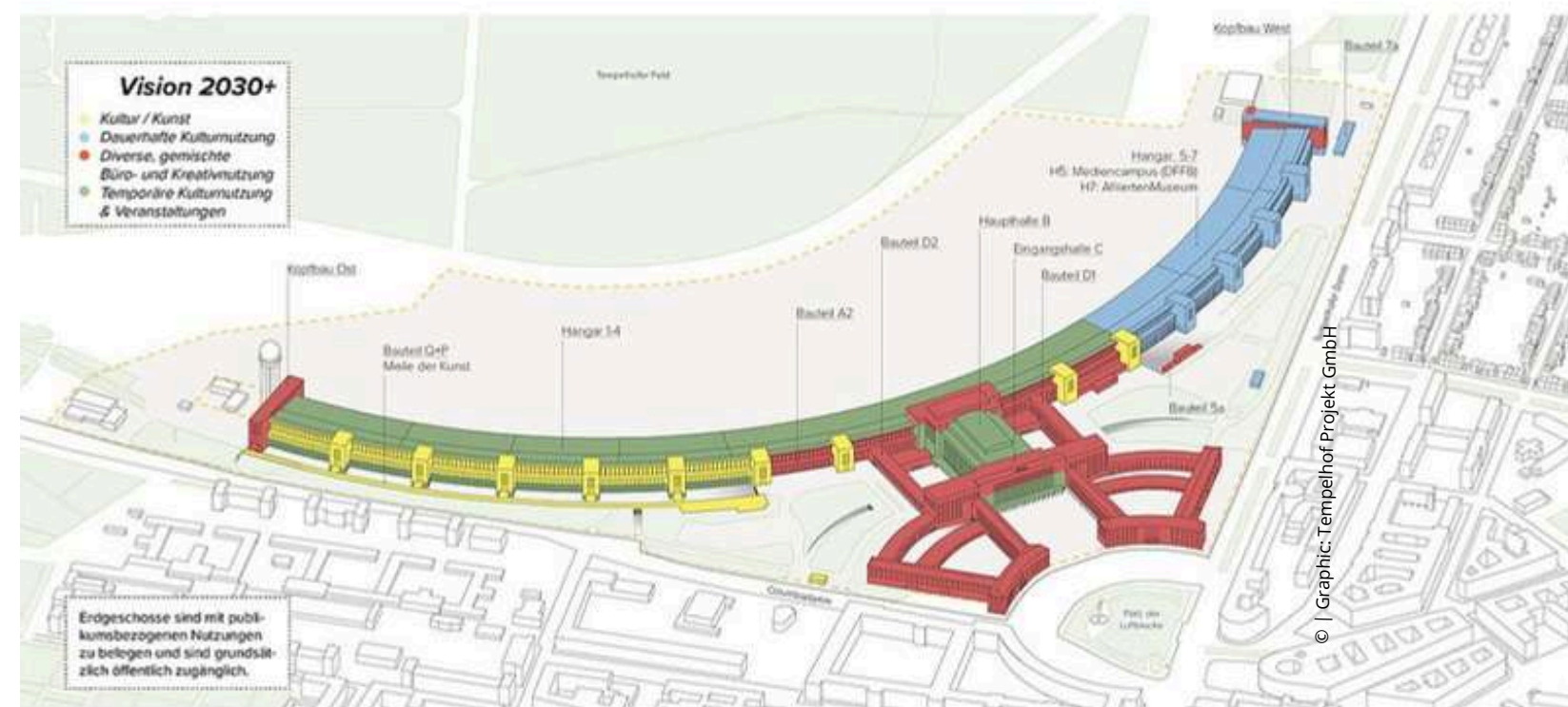

©Tempelhofer Feld



UNIVERSITÉ D'ARTOIS

Conclusion

Thank you !

Corentin Boisard, Alexane Conrozier, Léa Duhain, Léonie Dujardin, Amandine Favier, Nathan Hancart, Baptiste Hermant, Sami Lalot, Mathilde Mangniers & Angèle Pommeret



Tempelhof Airport © istockphoto.com